



25703 LOMITA LINDA COURT

SITE & HOME DETAILS

SITE PLAN



Site Plan

FLOOR PLANS

MAIN LEVEL



LOWER LEVEL



GUEST HOUSE



- Approximately 6,300± total square feet
- Main home: 5,936± sf
- Guest house: 413± sf

DETAILS OF THE HOME

- Impressive **front entrance** exudes the symmetrically balanced Palladian style of architecture; Doric columns and moldings with deep dentil detail surround a grand portico framing walnut double front doors
- Marble **foyer** with inlaid medallion, dentil moldings, and chandelier
- Step down formal **living and dining room** combination with barrel-vaulted ceiling and wall of glass with integrated Palladian window looking out to the Bay views; two sets of French doors open to the pool terrace; walnut finishes the floor
- **Living area** has a fireplace with cast stone mantelpiece beneath a retractable cinema screen and projector plus surround sound for main-level media needs
- **Dining area** has built-in cabinetry; walnut floors extend throughout and continue into the bar
- Mahogany and granite **bar** has elevated counter seating, U-Line ice maker and refrigerator, plus 2 Fisher & Paykel dishwasher drawers
- Custom maple and Anigre **kitchen** cabinetry topped in granite slab with backsplashes of tumbled marble; angular island with extension, chair-height concrete table by Buddy Rhodes studio; maple floors continue into the family room
- **Appliances** include: Thermador gas cooktop, 2 ovens, warming drawer, and dishwasher; GE microwave; Broan compactor; Sub-Zero refrigerator
- **Family room**, fully open to the kitchen with beamed cathedral ceiling, has a Palladian view window, concealed 5.1 surround sound, plus sliding glass doors to the pool terrace and to the side yard
- **Bedroom** with entire wall of custom cabinetry and integrated fireplace, contemporary sphere chandelier, and closet with retractable table for workspace, if needed
- **Office** with built-in desk center, wet bar with mini refrigerator, and adjacent closet with customized office storage
- **Bedroom** with outside entrance and direct access to a dual-entry **bath** with tumbled marble shower
- **Two bedrooms**, in the primary suite wing, each with built-in desk center, organized closet, sink vanity, and direct access to a **shared bath** with tub and overhead shower
- **Primary bedroom** suite has a dual-entrance walk-in closet, barrel-vaulted ceiling, Palladian view window, and two sets of sliding glass doors to the pool terrace; sky-lit **en suite bath** has heated floor and towel bar, dual-sink vanity, jetted tub, shower with South Bay view window reaching all the way to the San Jose airport, plus outside entrance and private commode room
- Lower-level **recreation room**, refreshment center with refrigerator, and **theatre** with projector, cinema screen, 5.1 surround sound, and acoustic paneled walls
- Customized, **temperature-controlled wine cellar** for approximately 1,500 bottles plus case storage with barrel-vaulted ceiling, beveled edge limestone walls, and trompe l'oeil painting
- **Guest house** with heated tile floor, air conditioning, built-in desk and Murphy bed, kitchen with electric range, dishwasher, and refrigerator, plus bath with shower
- **Rear grounds** include pergola-covered terrace with 4 heaters and sound speakers, **pool and spa** with retractable cover, outdoor shower, 2 parterre gardens each

PARCEL MAP

with tiered fountain, gas line for barbecue beside the pool house, 5-hole **putting green**, natural grass lawn for play, and **Chardonnay vineyard**

- Other features: formal **half-bath** and lower-level **half-bath**; **laundry room** with sink, drip-dry closet with fan, Speed Queen washer, and 2 Speed Queen dryers; manual dumb waiter between floors; 2 air conditioners with 3 zones; security alarm; Vantage programmable lighting; distributed sound speakers; extensive "enterprise class" network wiring; 400amp backup natural gas generator able to power the entire main residence; attached **3-car garage** with built-ins, workbench, Sapele mahogany doors, and epoxy floor

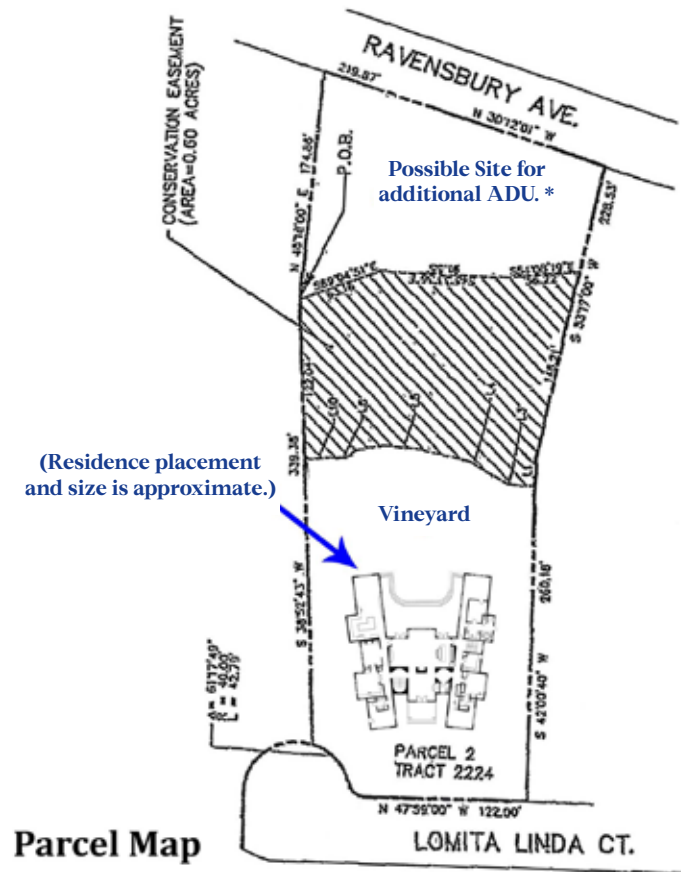

*Possible site for additional ADU. Buyers to verify with the Town of Los Altos Hills.



25703 LOMITA LINDA COURT
LOS ALTOS HILLS

SHOWINGS BY APPOINTMENT



FOXGROVER

KRISTI FOXGROVER

Broker Associate

650.823.4755

kristi@foxgrover.com

DRE #00909136

25703LomitaLinda.com

COMPASS

ML81864812

Kristi Foxgrover DRE License # 00909136. Compass is a licensed real estate broker (01991628) in the State of California and abides by Equal Housing Opportunity laws. All material presented herein is intended for informational purposes only. Information is compiled from sources deemed reliable but is subject to errors, omissions, changes in price, condition, sale, or withdrawn without notice. No statement is made as to accuracy of any description. All measurements and square footages are approximate. Exact dimensions can be obtained by retaining the services of an architect or engineer.