

520 LOMA ALTA

CARMEL CALIFORNIA



"A GEM IN THE HILLS ABOVE CARMEL"

520LomaAlta.com

\$3,999,000

Sited in the Jacks Peak section of Carmel, there awaits a feast for the senses. Two octagon structures, a spacious main house plus a guest wing, both with spectacular views of Monterey Bay from Pacific Grove to Santa Cruz. The property is sited on a fully fenced 5.2 acres, cross fenced for pets, four stall barn and three outside pens for horses or dogs. The structures offer 3 bedrooms and 5 baths, private patios, ocean-view decks...this is a true gem in the hills above Carmel.



GLOBAL
LUXURY

TIM ALLEN CalBRE#00891159

c 831.214.1990

TIMALLENPROPERTIES.COM

TIM ALLEN

PROPERTIES

©2014 Coldwell Banker Real Estate LLC. All Rights Reserved. Coldwell Banker® is a registered trademark licensed to Coldwell Banker Real Estate LLC. An Equal Opportunity Company. Equal Housing Opportunity. Each Coldwell Banker Residential Brokerage Office is Owned by a Subsidiary of NRT LLC. All rights reserved. This information was supplied by Seller and/or other sources. Broker believes this information to be correct but has not verified this information and assumes no legal responsibility for its accuracy. Buyers should investigate these issues to their own satisfaction. Real estate agents affiliated with Coldwell Banker Residential Brokerage are independent contractor sales associates and are not employees of Coldwell Banker Real Estate LLC, Coldwell Banker Residential Brokerage or NRT LLC. CalBRE License # 01908304.

FLOOR PLAN

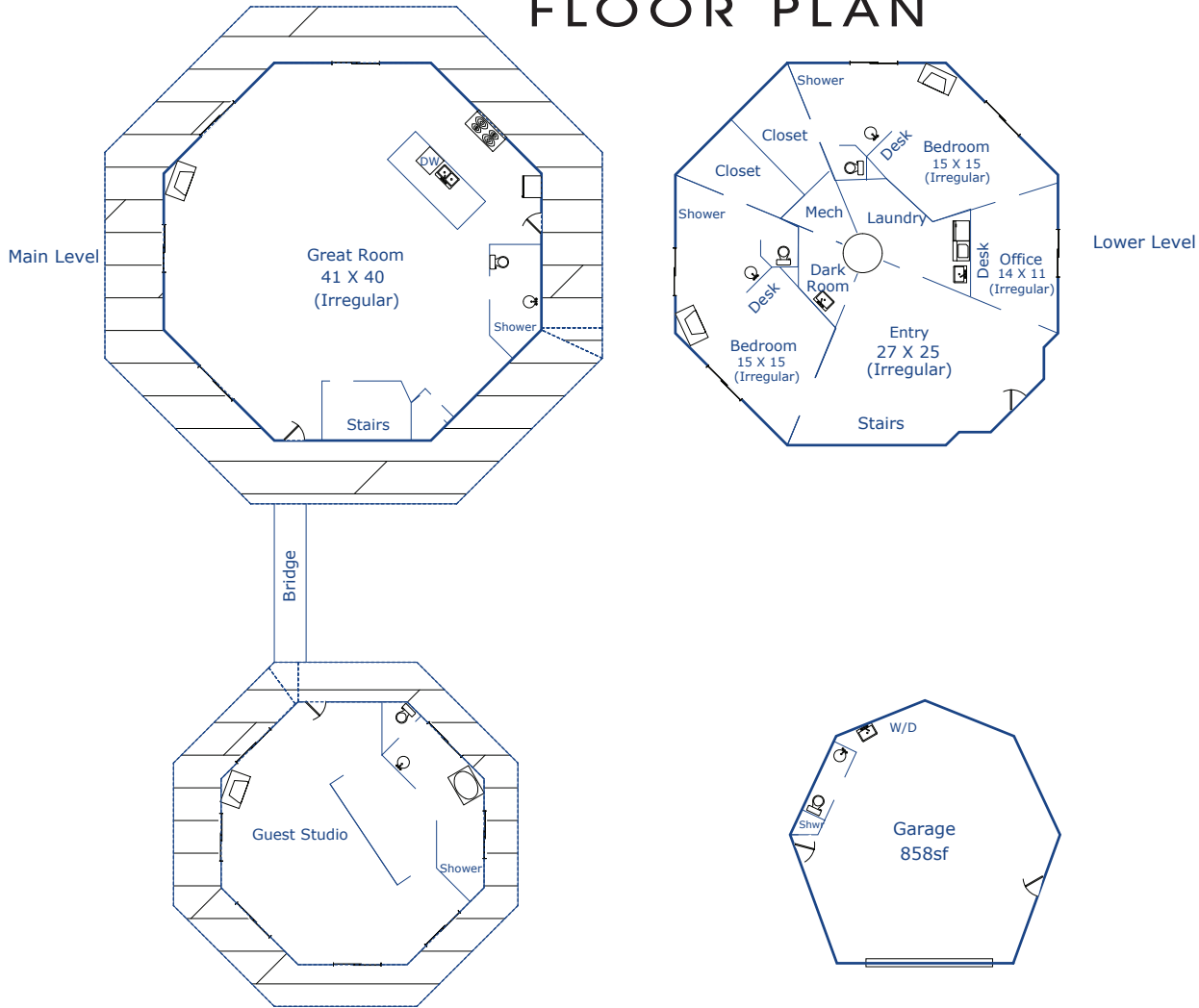

Main Living Area - 1883sf

Lower Level - 1966sf

Total - 3849sf

Guest Studio - 913sf

SPECIFICS

PROPERTY INFORMATION

Lot Size:	5.2+/- Acres
Total Square Footage:	3,849+/- SF
Exterior:	Stucco
Interior:	Plaster
Roof:	Composition
Fireplaces:	Four - LR / MBR / GST / BR
Floors:	Tile
Heat:	Radiant
Garage:	Two Car
Sewer / Septic:	Septic

MEASUREMENTS

Entry:	27 x 25 (Irregular)
Great Room:	41 x 40 (Irregular)
Number of Baths:	5
Office:	14 x 11
Master Bedroom:	15 x 15
Second Bedroom:	15 x 15
Guest House:	17 x 31